



RECIPROCATING SAW

RACSSB710

USER GUIDE

CAUTION: Read this manual before using this machine!

CONTENTS

1. INTENDED USE.....	3
2. SAFETY INSTRUCTIONS.....	3
3. YOUR PRODUCT.....	6
4. OPERATION.....	7
5. CLEANING AND CARE.....	11
6. REPAIR AND MAINTENANCE.....	11
7. STORAGE AND TRANSPORTATION.....	11
8. DISPOSAL.....	11
9. DECLARATION OF CONFORMITY.....	12
10. WARRANTY.....	13
11. PRODUCT FAILURE.....	14
12. WARRANTY EXCLUSIONS.....	15

1. INTENDED USE

The reciprocating saw is intended for cutting wood, metal and plastic.

Following the instructions contained in this manual guarantees safe operation of the device.

The device is designed for private use at home only and may not be used for professional purposes.

2. SAFETY INSTRUCTIONS

2.1 GENERAL POWER TOOL SAFETY WARNINGS



WARNING! Read all safety warnings, instructions, illustrations and specifications provided with this power tool. *Failure to follow all instructions listed below may result in electric shock, fire and/or serious injury.*

Save all warnings and instructions for future reference. *The term "power tool" in the warnings refers to your mains-operated (corded) power tool or battery-operated (cordless) power tool.*

1) Work area safety

a) Keep work area clean and well lit. *Cluttered or dark areas invite accidents.*

b) Do not operate power tools in explosive atmospheres, such as in the presence of flammable liquids, gases or dust. *Power tools create sparks which may ignite the dust or fumes.*

c) Keep children and bystanders away while operating a power tool. *Distractions can cause you to lose control.*

2) Electrical safety

a) Power tool plugs must match the outlet. Never modify the plug in any way. Do not use any adapter plugs with earthed (grounded) power tools. *Unmodified plugs and matching outlets will reduce risk of electric shock.*

b) Avoid body contact with earthed or grounded surfaces, such as pipes, radiators, ranges and refrigerators. *There is an increased risk of electric shock if your body is earthed or grounded.*

c) Do not expose power tools to rain or wet conditions. *Water entering a power tool will increase the risk of electric shock.*

d) Do not abuse the cord. Never use the cord for carrying, pulling or unplugging the power tool. Keep cord away from heat, oil, sharp edges or moving parts. *Damaged or entangled cords increase the risk of electric shock.*

e) When operating a power tool outdoors, use an extension cord suitable for outdoor use. *Use of a cord suitable for outdoor use reduces the risk of electric shock.*

f) If operating a power tool in a damp location is unavoidable, use a residual current device (RCD) protected supply. *Use of an RCD reduces the risk of electric shock.*

3) Personal safety

a) Stay alert, watch what you are doing and use common sense when operating a power tool. Do not use a power tool while you are tired or under the influence of drugs, alcohol or medication. *A moment of inattention while operating power tools*

b) Use personal protective equipment. Always wear eye protection. *Protective equipment such as a dust mask, non-skid safety shoes, hard hat or hearing protection used for appropriate conditions will reduce personal injuries.*

c) Prevent unintentional starting. Ensure the switch is in the off-position before connecting to power source and/or battery pack, picking up or carrying the tool. *Carrying power tools*

with your finger on the switch or energising power tools that have the switch on invites accidents.

d) Remove any adjusting key or wrench before turning the power tool on. *A wrench or a key left attached to a rotating part of the power tool may result in personal injury.*

e) Do not overreach. Keep proper footing and balance at all times. *This enables better control of the power tool in unexpected situations.*

f) Dress properly. Do not wear loose clothing or jewellery. Keep your hair and clothing away from moving parts. *Loose clothes, jewellery or long hair can be caught in moving parts.*

g) If devices are provided for the connection of dust extraction and collection facilities, ensure these are connected and properly used. *Use of dust collection can reduce dust-related hazards.*

h) Do not let familiarity gained from frequent use of tools allow you to become complacent and ignore tool safety principles. *A careless action can cause severe injury within a fraction of a second.*

4) Power tool use and care

a) Do not force the power tool. Use the correct power tool for your application. *The correct power tool will do the job better and safer at the rate for which it was designed.*

b) Do not use the power tool if the switch does not turn it on and off. *Any power tool that cannot be controlled with the switch is dangerous and must be repaired.*

c) Disconnect the plug from the power source and/or remove the battery pack, if detachable, from the power tool before making any adjustments, changing accessories, or storing power tools. *Such preventive safety measures reduce the risk of starting the power tool accidentally.*

d) Store idle power tools out of the reach of children and do not allow persons unfamiliar with the power tool or these instructions to operate the power tool. *Power tools are dangerous in the hands of untrained users.*

e) Maintain power tools and accessories. Check for misalignment or binding of moving parts, breakage of parts and any other condition that may affect the power tool's operation. If damaged, have the power tool repaired before use. *Many accidents are caused by poorly maintained power tools.*

f) Keep cutting tools sharp and clean. *Properly maintained cutting tools with sharp cutting edges are less likely to bind and are easier to control.*

g) Use the power tool, accessories and tool bits etc. in accordance with these instructions, taking into account the working conditions and the work to be performed. *Use of the power tool for operations different from those intended could result in a hazardous situation.*

h) Keep handles and grasping surfaces dry, clean and free from oil and grease. *Slippery handles and grasping surfaces do not allow for safe handling and control of the tool in unexpected situations.*

5) Service









a) Have your power tool serviced by a qualified repair person using only identical replacement parts. *This will ensure that the safety of the power tool is maintained.*

2.2 ADDITIONAL SAFETY INSTRUCTIONS FOR RECIPROCATING SAWS

a) Hold the power tool by insulated gripping surfaces, when performing an operation where the cutting accessory may contact hidden wiring or its own cord. *Cutting accessory contacting a "live" wire may make exposed metal parts of the power tool "live" and could give the operator an electric shock.*

b) Use clamps or another practical way to secure and support the workpiece to a stable platform. Holding the workpiece by hand or against your body leaves it unstable and may lead to loss of control.

2.3 EXPLANATION OF SYMBOLS

	General warning sign, draws the attention of any operator to general hazards. Used in combination with other warning notes or symbols, which, if not observed, may result in injuries or damage to the device.
	Product compliant with the requirements of the applicable European Union directives.
	To reduce the risk of injury, the user must read and understand this manual before using this product.
	Wear ear protectors. Exposure to noise can cause hearing loss.
	Wear eye protection.
	Wear respiratory protection.
	Do not dispose of old appliances with domestic rubbish.
	Class II tool, double isolation.
	Disconnect the device from the source of power.

3. YOUR PRODUCT

3.1 DESCRIPTION

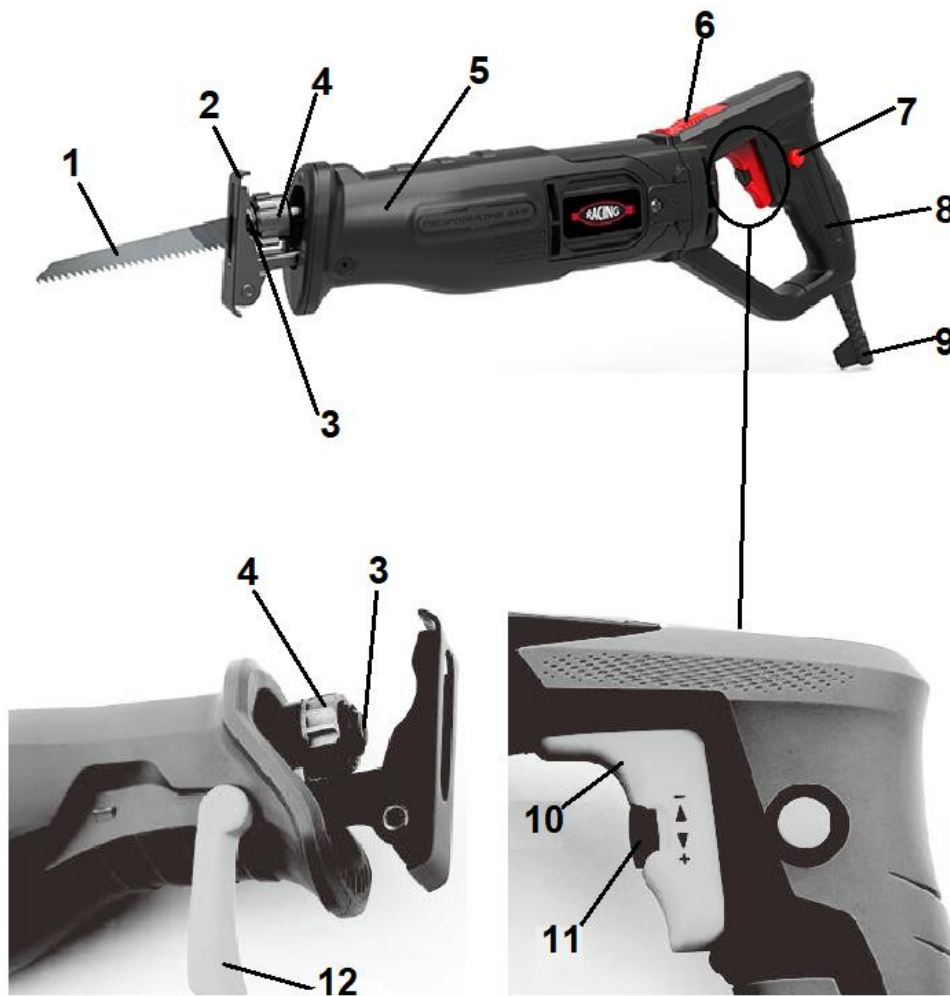

- 1. Saw blade
- 2. Shoe
- 3. Blade socket
- 4. Blade clamp sleeve
- 5. Housing
- 6. Handle rotation lock
- 7. Trigger switch lock
- 8. Handle
- 9. Power cord
- 10. Trigger switch
- 11. Reciprocating action speed adjustment knob
- 12. Shoe adjustment lock

3.2 KIT CONTENTS

The kit should contain the following components.

Quantity	component
1	Reciprocating saw 710W with rotatable handle
1	Blade for cutting wood
1	Instruction manual

Open the packaging and carefully take the device out. Make sure that the kit is complete and that its components are undamaged. Check that plastic parts are not broken and the power cord is not damaged, If you find that any components are missing or damaged, contact the vendor and do not use the device. Retain the packaging or dispose of it in accordance with local regulations.



Attention! To keep children safe, do not leave packaging parts (plastic bags, cardboard boxes, expanded polystyrene elements etc.) freely accessible. Danger of suffocation!

3.3 TECHNICAL DATA

Tension	230-240V~, 50Hz
No load speed	0-2800/min
Rated power	710W
Stroke length	20mm
Cutting capacity	150mm in wood / 10mm in metal / 18mm in Alu
Sound power level	L_{wA} : 105,1dB(A) K=5dB(A)
Sound pressure level	L_{pA} : 97,1dB(A) K=5dB(A)
Vibration	Cutting board mode: - Front handle $a_{h,B}$: 8,521 m/s ² - Rear handle $a_{h,B}$: 7,433 m/s ² Cutting wooden beams mode - Front handle $a_{h,WB}$: 7,630 m/s ² - Rear handle $a_{h,WB}$: 6,530 m/s ² K= 1,5m/s ²

INFORMATION

- The declared vibration total value(s) and the declared noise emission value(s) have been measured in accordance with a standard test method and may be used for comparing one tool with another.
- The declared vibration total value(s) and the declared noise emission value(s) may also be used in a preliminary assessment of exposure.

WARNING!

- The vibration and noise emissions during actual use of the power tool can differ from the declared values depending on the ways in which the tool is used especially what kind of workpiece is processed.
- Need to identify safety measures to protect the operator that are based on an estimation of exposure in the actual conditions of use (taking account of all parts of the operating cycle such as the times when the tool is switched off and when it is running idle in addition to the trigger time).
- Wear hearing protection.

4. OPERATION

4.1 SAW ASSEMBLY/DISASSEMBLY

- Make sure that the tool is disconnected from the power source.
- Select the blade suitable for the material to be cut.
- Turn the blade clamp sleeve(4)ca40° counter-clockwise and hold it in that position.



Blade for cutting metal(deliver without this blade)

Blade for cutting wood

Blade for cutting plastic(deliver without this blade)

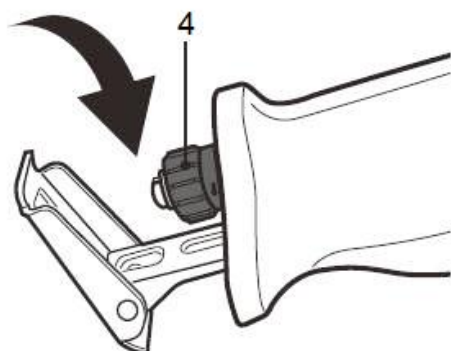

d) Insert the blade and release the blade clamp sleeve(4).

NOTE:The blade may be installed with the cutting edge directed downwards or upwards, depending on how you are going to use the saw.

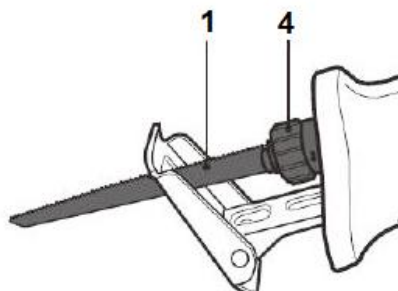
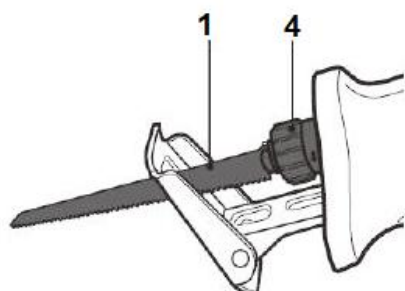

NOTE: Pull on the blade(1) to make sure that it has been secured properly. The blade should not move in the blade clamp sleeve(4).

To remove the blade(1), turn the blade clamp sleeve(4)ca.40°counter-clockwise. Then pullout the blade to remove it.

⚠ Caution! Injury hazard! The blade teeth are very sharp.

4.2 SWITCHING THE DEVICE ON/OFF

To start the device:

- Connect the device to a source of 230-240V~, 50Hz alternating current.
- Grasp the handle(8)firmly with one hand.
- Hold the housing(5)with the other hand.
- Push the trigger switch(10)

To turn the device off,release the trigger switch and disconnect the device from the power source.

⚠ Attention! If the trigger switch is locked with the trigger switch lock(7), turn the device off by pressing and releasing the trigger switch(10).

⚠ Caution! Injury hazard! Be careful, because after the device is turned off, the blade will continue to move due to inertia.

4.3 RECIPROCATING ACTION SPEED ADJUSTMENT

The reciprocating action speed may be adjusted with the reciprocating action speed adjustment knob (11). To decrease the reciprocating action speed, turn the knob up towards the "-" symbol. To increase the reciprocating action speed, turn the knob down towards the "+" symbol.

The reciprocating action speed can be adjusted also using the trigger switch(10). To increase the reciprocating action speed, increase pressure on the trigger switch.

4.4 TRIGGER SWITCH LOCK(7)

To lock the trigger switch(for example, when cutting for an extended time), press the trigger switch(10), then press the trigger switch lock(7).

To unlock the trigger switch, press and release the trigger switch.

4.5 SHOE(2)

When cutting material, always press the saw shoe against the work piece.

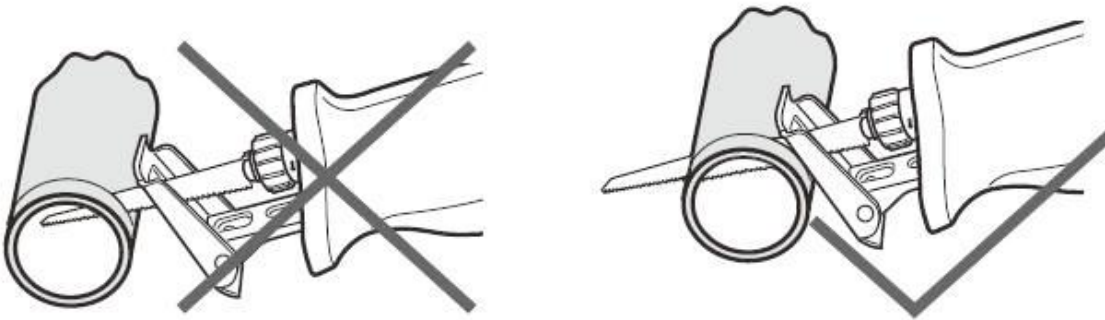

To adjust the length of the shoe support arm, first release the shoe adjustment lock(12) by pushing it strongly out at the groove, so that the lock assumes a vertical position. Next, you can adjust the shoe(2) position by pulling it out or pushing it in. To lock the shoe(2), activate the shoe adjustment lock(12) by setting it in a horizontal position. If the lock is set correctly, you will hear a distinctive "click" sound. Pictures of the lock in a released and set position can be found below.



⚠ Caution! Injury hazard! Never operate the power tool without the shoe adjustment lock(12) set.

The shoe angle can also be set manually by tilting the shoe forcefully forward or backwards.

4.6 HANDLE POSITION ADJUSTMENT

To change the handle position,grab the handle(8), push the handle rotation lock (6)and rotate the handle 90° to the left or to the right.

4.7 CUTTING ADVICE

The appropriate reciprocating action speed depends on the material and on the working conditions. It can be determined by means of a practical test.

It is recommended that the reciprocating action speed be decreased at the start of cutting and whenever cutting plastics.

Long operation at a lower reciprocating action speed may result in overheating of the power tool. To restore the proper temperature, remove the blade from the work piece and turn the power tool on at full speed for ca.1 minute.

⚠ Caution! Risk of burns! Be careful because during operation the blade becomes hot due to friction. It takes much more time to cut metal than to cut wood. Use suitable blades for cutting metal. Before cutting, apply a thin layer of oil on the cutting line.

Cutting methods and blade positions

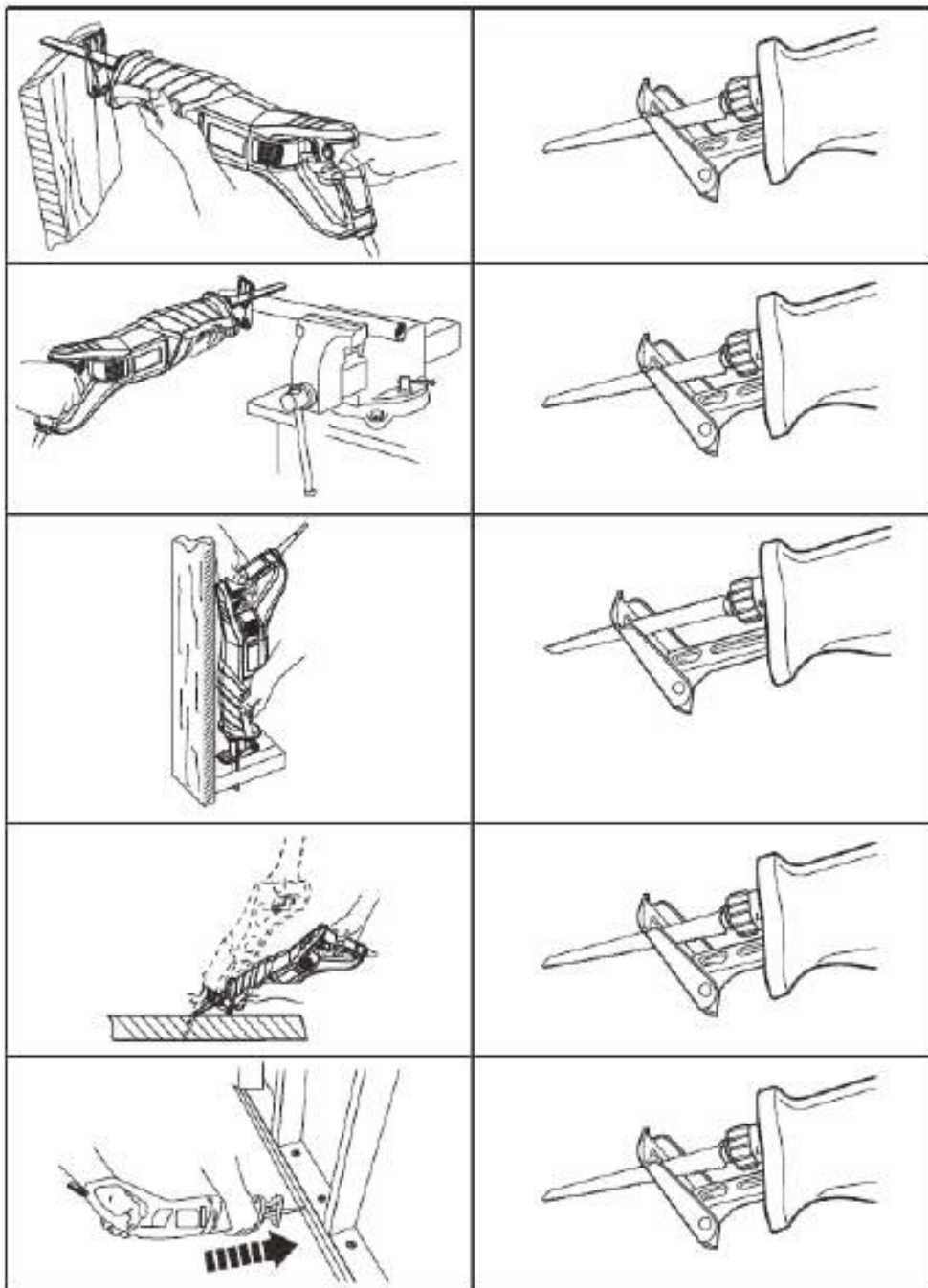

5. CLEANING AND CARE

Proper and regular cleaning will ensure safe operation and extend the life span of the device.



Warning! Before performing cleaning and maintenance operations, turn the device off and let it cool down, so as to avoid burns.

Protective devices, vents and the motor housing should be free of dust or contaminants whenever possible.

Wipe the device with a dry cloth or blow it down with low-pressure compressed air.

It is recommended that the device be cleaned immediately after every use.

Make sure no water penetrates into the device.

NOTE! Do not clean the power tool with any strong chemicals, alkali, abrasive or disinfecting agents, as they may damage the surface of the device.

If the tool produces excessive amounts of sparks, the carbon brushes need to be inspected by an electrician.



Attention! The carbon brushes may be replaced only by a qualified electrician.

Carefully inspect the condition of the blades.

1/2" all-purpose blades for reciprocating saws can be used with the device.

Blades for various uses can be purchased from specialist stores.

Carefully select the proper blade for the type of work you plan to do.

6. REPAIR AND MAINTENANCE

The device does not contain any user-serviceable parts. Do not repair the device on your own. Always have the device repaired by a professional.

If the power cord is damaged, it has to be replaced by the manufacturer, by a service centre or by a qualified individual, with an identical cord or with a cord whose parameters are identical with those of the original cord.

7. STORAGE AND TRANSPORTATION

a) Clean the device as described. We recommend storing the device in its original package.

b) Always keep the device in a dry, well-ventilated location inaccessible to children.

c) Protect the device against vibration and shock during transport

8. DISPOSAL



Electrical products should not be discarded with household products. According to the European Directive 2012/19/UE on waste electrical and electronic equipment and its implementation into national law, electrical products used must be collected separately and disposed of at collection points provided for this purpose. Talk with your local authorities or dealer for advice on recycling.

9. DECLARATION OF CONFORMITY



BUILDER SAS

**32, rue Aristide Bergès - ZI 31270 Cugnaux – France
declare that the machine**

Designation: Reciprocating saw

Model: RACSSB710

Serial number: 20230704031-20230704530

Is in conformity with the European Directives:

Machine Directive 2006/42/EC

EMC Directive 2014/30/EU

RoHs Directive (EU)2015/863 amending 2011/65/EU

This product is also in conformity with the following standards:

EN62841-1:2015+A11:2022

EN 62841-2-11:2016+A1:2020

EN IEC 55014-1:2021;

EN IEC 55014-2:2021

EN IEC 61000-3-2:2019+A1:2021;

EN 61000-3-3:2013+A2:2021

The technical documentation is kept by: Olivier Patriarca

Cugnaux, 10/05/2023

A handwritten signature in black ink, appearing to read 'Philippe MARIE', with a large, stylized initial 'P'.

Philippe MARIE / PDG

10. WARRANTY



WARRANTY

The manufacturer guarantees the product against defects in material and workmanship for a period of 2 years from the date of the original purchase. The warranty only applies if the product is for household use. The warranty does not cover breakdowns due to normal wear and tear.

The manufacturer agrees to replace parts identified as defective by the designated distributor. The manufacturer does not accept responsibility for the replacement of the machine, in whole or in part, and/or ensuing damage.

The warranty does not cover breakdowns due to:

- insufficient maintenance.
- abnormal assembly, adjustment or operations of the product.
- parts subject to normal wear and tear.

The warranty does not extend to:

- shipping and packaging costs.
- using the tool for a purpose other than that for which it was designed.
- the use and maintenance of the machine done in a manner not described in the user manual.

Due to our policy of continuous product improvement, we reserve the right to alter or change specifications without notice. Consequently, the product may be different from the information contained therein, but a modification will be undertaken without notice if it is recognized as an improvement of the preceding characteristic.

READ THE MANUAL CAREFULLY BEFORE USING THE MACHINE.

When ordering spare parts, please indicate the part number or code, you can find this in the spare parts list in this manual. Keep the purchase receipt; without it, the warranty is invalid. To help you with your product, we invite you to contact us by phone or via our website:

- **+33 (0)9.70.75.30.30**
- **<https://services.swap-europe.com/contact>**

You must create a "ticket" via the web platform.

- Register or create your account.
- Indicate the reference of the tool.
- Choose the subject of your request.
- Describe your problem.
- Attach these files: invoice or sales receipt, photo of the identification plate (serial number), photo of the part you need (for example: pins on the transformer plug which are broken).



11. PRODUCT FAILURE

WHAT TO DO IF MY MACHINE BREAKS DOWN?

If you bought your product in a store:

- a) Empty the fuel tank if your product has one.
- b) Make sure that your machine is complete with all accessories supplied, and clean! If this is not the case, the repairer will refuse the machine.

Go to the store with the complete machine and with the receipt or invoice.

If you bought your product on a website:

- a) Empty the fuel tank if your product has one.
- b) Make sure that your machine is complete with all accessories supplied, and clean! If this is not the case, the repairer will refuse the machine.
- c) Create a SWAP-Europe service ticket on the site: <https://services.swap-europe.com> When making the request on SWAP-Europe, you must attach the invoice and the photo of the nameplate (serial number).
- d) Contact the repair station to make sure it is available before dropping off the machine.

Go to the repair station with the complete machine packed, accompanied by the purchase invoice and the station support sheet downloadable after the service request is completed on the SWAP-Europe site

For machines with engine failure from manufacturers BRIGGS & STRATTON, HONDA and RATO, please refer to the following instructions.

Repairs will be done by approved engine manufacturers of these manufacturers, see their site:

- <http://www.briggsandstratton.com/eu/fr>
- <http://www.honda-engines-eu.com/fr/service-network-page;jsessionid=5EE8456CF39CD572AA2AEEDFD290CDAE>
- <https://www.rato-europe.com/it/service-network>

Please keep your original packaging to allow for after-sales service returns or pack your machine with a similar cardboard box of the same dimensions.

For any question concerning our after-sales service you can make a request on our website <https://services.swap-europe.com>

Our hotline remains available at +33 (9) 70 75 30 30.



12. WARRANTY EXCLUSIONS

THE WARRANTY DOES NOT COVER:

- Start-up and setting up of the product.
- Damage resulting from normal wear and tear of the product.
- Damage resulting from improper use of the product.
- Damage resulting from assembly or start-up not in accordance with the user manual.
- Breakdowns related to carburetion beyond 90 days and fouling of carburetors.
- Periodic and standard maintenance events.
- Actions of modification and dismantling that directly void the warranty.
- Products whose original authentication marking (brand, serial number) has been degraded, altered or withdrawn.
- Replacement of consumables.
- The use of non-original parts.
- Breakage of parts following impacts or projections.
- Accessories breakdowns.
- Defects and their consequences linked to any external cause.
- Loss of components and loss due to insufficient screwing.
- Cutting components and any damage related to the loosening of parts.
- Overload or overheating.
- Poor power supply quality: faulty voltage, voltage error, etc.
- Damages resulting from the deprivation of enjoyment of the product during the time necessary for repairs and more generally the costs related to the immobilization of the product.
- The costs of a second opinion established by a third party following an estimate by a SWAP-Europe repair station
- The use of a product which would show a defect or a breakage which was not the subject of an immediate report and/or repair with the services of SWAP-Europe.
- Deterioration linked to transport and storage*.
- Launchers beyond 90 days.
- Oil, petrol, grease.
- Damages related to the use of non-compliant fuels or lubricants.

* In accordance with transport legislation, damage related to transport must be declared to carriers within 48 hours maximum after observation by registered letter with acknowledgement of receipt.

This document is a supplement to your notice, a non-exhaustive list.

Attention: all orders must be checked in the presence of the delivery person. In case of refusal by the delivery person, it you must simply refuse the delivery and notify your refusal.

Reminder: the reserves do not exclude the notification by registered letter with acknowledgement within 72 hours.

Information: Thermal devices must be wintered each season (service available on the SWAP-Europe site). Batteries must be charged before being stored.



BUILDER SAS
32, rue Aristide Bergès - ZI 31270 Cugnaux - France
MADE IN PRC 2023